

CORNER RECORD

Document Number CR 7777

UNINCORPORATED EDEN TOWNSHIP County of ALAMEDA, California

Brief Legal Description WELL MONUMENT LOCATED WITHIN A STREET.

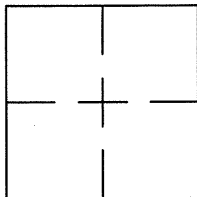

CORNER RECORD

Government Corner ☐ Control ☒
Meander ☐ Property ☐
Rancho ☐ Other ☐
Date of Survey 11/17/2015

COORDINATES
(Optional)

N. 2074023±
E. 6106140±
Zone 3 Datum _____
Elev. _____

Corner — Left as found ☒ Found and tagged ☐ Established ☐ Reestablished ☐ Rebuilt ☐

Identification and type of corner found: Evidence used to identify or procedure used to establish or reestablish the corner:
FOUND MONUMENT WELL WITH MISSING CORE. FOUND "2-FOOT" STRADDLER NAILS.

POSITION OF MONUMENT TAKEN AT INTERSECTION OF STRADDLER NAILS.

THIS POINT WAS REFERENCED PRIOR TO A CONSTRUCTION
PROJECT IN THE VICINITY

A description of the physical condition of the monument as found and as set or reset: _____
FOUND AND SET POINTS AS SHOWN ON PAGE 2.

THESE TIES ARE FOR THE PURPOSE OF PERPETUATING THE FOUND MONUMENTATION.

NO CLAIM IS MADE AS TO THE RELATIONSHIP OF THE POINTS OR LINES SHOWN HEREON
TO TRUE BOUNDARY LOCATIONS.

SURVEYOR'S STATEMENT

This Corner Record was prepared by me or under my direction in conformance with
the Land Surveyors' Act on December 3, 2015.

Signed Scott V. Cunha L.S. Number 8525
Exp. 12/31/16



COUNTY SURVEYOR'S STATEMENT

This Corner Record was received 12-07 2015 and examined
and filed 12-21 2015.

Signed Albert Jordan Title Deputy County Surveyor

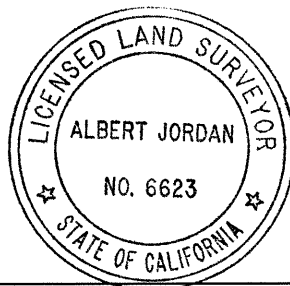

County Surveyor's Comment _____

SPEC 2261-PRE

R23427



SCALE: 1"=30'

LEGEND

◈ FOUND MONUMENT WELL WITH MISSING CONCRETE CORE. MEASUREMENT TAKEN AT INTERSECTION OF FOUND STRADDLER NAILS.

△ FOUND RAILROAD SPIKE

○ FOUND IRON PIN

● SET REBAR & CAP

⊗ SET CUT CROSS IN WALK

× SET PK NAIL & LARGE SHINER

✕ SET CUT CROSS IN CURB

AA##A# ALAMEDA COUNTY MONUMENT ID

19592 STREET ADDRESS

