

OWNER'S CERTIFICATE

The undersigned certify that as of the date of recordation of this condominium plan we are representatives of the record owners of the real property described herein. We further certify that we consent to the recordation of this plan in the office of the county recorder of the County of Mono, California.

Timber Ridge Homeowners Association, a California Corporation

Linda Lewis
Name Linda Lewis
President

Terry D. Prentice
Name TERRY D. PRENTICE
Secretary

SURVEYOR'S CERTIFICATE

I hereby certify that I am a Licensed Land Surveyor of the State of California and that this amended plan consisting of 2 sheets correctly represents the proposed locations of air spaces.

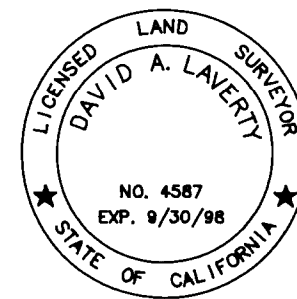

David A. Lavery
David A. Lavery, L.S. 4587
Expires 9/30/98

LEGAL DESCRIPTION

Unit 20/22 of Tract No. 36-34, Timber Ridge Villas, as recorded in Book 8 of Maps at Page 28, filed in the office of the County Recorder, Mono County, California.

CC&R's

The declarations of restrictions are recorded in Vol 162 at Page 137, Vol 596 at Page 480, and Vol 741 at Page 270 of Official Records, filed in the office of the County Recorder, Mono County, California.

RECORDER'S CERTIFICATE

Document No. #3524 filed this 9th day of July, 1996, at 11:18 A.M., in book 2 of condominium plans at pages 16-16A at the request of Timber Ridge Villas Homeowners Association, a California corporation.

Vera M. Mills
County Recorder Deputy

State of CA } ss.
County of MONO

On 7/6 before me,

Vicki L. Bowman
a Notary Public in and for said County and State, personally appeared

Linda Lewis and Terry D. Prentice
☐ personally known to me - OR - ☒ proved to me on the basis of satisfactory evidence to be the person(s) whose name(s) is/are subscribed to the within instrument and acknowledged to me that he/she/they executed the same in his/her/their authorized capacity(ies), and that by his/her/their signature(s) on the instrument the person(s), or the entity upon behalf of which the person(s) acted, executed the instrument.

WITNESS my hand and (optional) official seal:

Vicki L. Bowman
Notary Public (sign and print name)
My commission expires: 12-26-98
County of my principal place of business: MONO

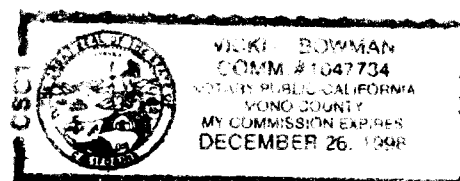

State of CA } ss.
County of MONO

On _____ before me,

_____ a Notary Public in and for said County and State, personally appeared

☐ personally known to me - OR - ☐ proved to me on the basis of satisfactory evidence to be the person(s) whose name(s) is/are subscribed to the within instrument and acknowledged to me that he/she/they executed the same in his/her/their authorized capacity(ies), and that by his/her/their signature(s) on the instrument the person(s), or the entity upon behalf of which the person(s) acted, executed the instrument.

WITNESS my hand and (optional) official seal:

Notary Public (sign and print name)
My commission expires: _____
County of my principal place of business: _____

**AMENDED CONDOMINIUM PLAN
FOR TRACT NO. 36-34**

TIMBER RIDGE VILLAS
BEING A MERGER OF UNITS 20 AND 22 AND
A RESUBDIVISION OF THOSE UNITS WITH LOT A
OF TRACT MAP NO. 36-34 RECORDED IN
BOOK 8 OF MAPS AT PAGE 28 IN THE
OFFICE OF THE MONO COUNTY RECORDER.
LOCATED IN THE TOWN OF MAMMOTH LAKES,
MONO COUNTY, CALIFORNIA.