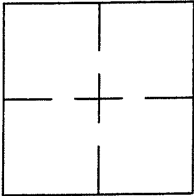

## CORNER RECORD

Document Number CR 6892City of OAKLANDCounty of ALAMEDA, CaliforniaBrief Legal Description WELL MONUMENT LOCATED WITHIN THE INTERSECTION OF COLLEGE AVENUE AND KEITH AVENUE.

## CORNER RECORD

Government Corner ☐ Control ☒  
 Meander ☐ Property ☐  
 Rancho ☐ Other ☐  
 Date of Survey 12/22/2014

COORDINATES  
(Optional)

N. \_\_\_\_\_  
 E. \_\_\_\_\_  
 Zone \_\_\_\_\_ Datum \_\_\_\_\_  
 Elev. \_\_\_\_\_

Corner — Left as found ☒ Found and tagged ☐ Established ☐ Reestablished ☐ Rebuilt ☐

Identification and type of corner found: Evidence used to identify or procedure used to establish or reestablish the corner:  
FOUND BRASS DISK IN WELL MONUMENT.

AS SHOWN ON CITY OF OAKLAND MONUMENT MAP, PAGE 321.

CITY MONUMENT DESIGNATION NUMBER AT SUBJECT LOCATION 55W52R

THIS POINT WAS REFERENCED PRIOR TO A CONSTRUCTION PROJECT IN THE VICINITY.

A description of the physical condition of the monument as found and as set or reset:

FOUND AND SET POINTS AS SHOWN ON PAGE 2.

THESE TIES ARE FOR THE PURPOSE OF PERPETUATING THE FOUND MONUMENTATION.

NO CLAIM IS MADE AS TO THE RELATIONSHIP OF THE POINTS OR LINES SHOWN HEREON TO TRUE BOUNDARY LOCATIONS.

## SURVEYOR'S STATEMENT

This Corner Record was prepared by me or under my direction in conformance with the Land Surveyors' Act on JANUARY 9, 20 15.

Signed Vincent H. Cunha L.S. Number LS 4520



## COUNTY SURVEYOR'S STATEMENT

This Corner Record was received 1-12-2015 and examined

and filed 2-28-2015

Signed Russell R. Penland Title County Surveyor

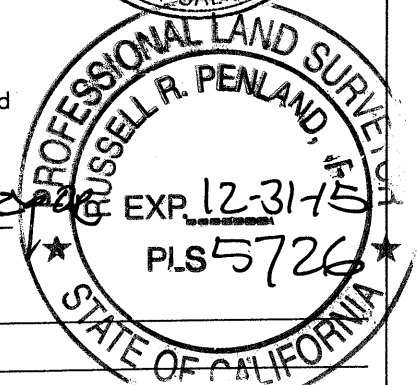

County Surveyor's Comment \_\_\_\_\_



SCALE: 1"=30'

## LEGEND

● FOUND BRASS DISK IN MONUMENT WELL (5SW52R)

✕ SET CUT CROSS IN CONCRETE

AA##A# ALAMEDA COUNTY MONUMENT ID

