

OWNERS STATEMENT

WE HEREBY STATE THAT WE ARE THE OWNERS OF OR HAVE SOME RIGHT, TITLE OR INTEREST IN AND TO THE REAL PROPERTY INCLUDED WITHIN THE SUBDIVISION SHOWN UPON THIS MAP, AND THAT WE ARE THE ONLY PERSON WHOSE CONSENT IS NECESSARY TO PASS CLEAR TITLE TO SAID PROPERTY; AND WE HEREBY CONSENT TO THE MAKING OF AND RECORRATION OF THE WITHIN MAP AND SUBDIVISION AS SHOWN WITHIN THE DISTINCTIVE BORDER LINE.

WE HEREBY DEDICATE TO PUBLIC USE SERA STREET AND CANYON OAK WAY FOR STREET PURPOSES AS SHOWN ON SAID MAP AND WITHIN SAID SUBDIVISION.

WE HEREBY DEDICATE TO THE PUBLIC EASEMENTS WITH THE RIGHT OF INGRESS AND EGRESS AND THE RIGHT TO CONSTRUCT, REPAIR, REPLACE AND MAINTAIN APPLICABLE STRUCTURES AND APPURTENANCES UNDER UPON, AND OVER ANY AREA OF LAND DESIGNATED AS "P.U.E. (PUBLIC UTILITY EASEMENT)" OR E. (OVERLAND RELEASE EASEMENT) AND S.D.E. (STORM DRAIN EASEMENT) AS ELUCIDATED AND DESIGNATED ON SAID MAP. SAID AREAS OR STRIPS OF LAND ARE TO BE KEPT OPEN AND FREE FROM BUILDINGS AND STRUCTURES OF ANY KIND EXCEPT APPLICABLE UTILITY STRUCTURES AND APPURTENANCES AND LAWFUL FENCES.

WE HEREBY DEDICATE TO PUBLIC USE EASEMENTS FOR PUBLIC ACCESS UNDER, ON AND OVER THOSE CERTAIN STRIPS OF LAND SHOWN AS P.A.E. (PUBLIC ACCESS EASEMENTS).

WE HEREBY RESERVE FOR THE USE AND ENJOYMENT OF THE RESIDENTS OF SAID SUBDIVISION THOSE CERTAIN AREAS OR STRIPS OF LAND DELINEATED AND DESIGNATED AS "PRIVATE OPEN SPACE" AS SHOWN ON SAID MAP AND AS MORE FULLY DEFINED IN THE OAK VALLEY CONDITIONS, COVENANTS AND RESTRICTIONS.

WE HEREBY DEDICATE TO THE CITY OF CUPERTINO, PARCEL A AS SHOWN ON SAID MAP, FOR PARK PURPOSES.

WE HEREBY RESERVE THOSE CERTAIN STRIPS OF LAND DESIGNATED AS P.S.D.E. (PRIVATE STORM DRAIN EASEMENT) TO BE CREATED AND GRANTED BY SEPARATE DOCUMENT.

AS OWNERS:

THE O'BRIEN GROUP, A CALIFORNIA CORPORATION

BY: Dennis O'Brien
DENNIS O'BRIEN, PRESIDENT

OWNERS ACKNOWLEDGMENT

STATE OF CALIFORNIA)
) S.S.

COUNTY OF San Mateo

ON 5.14 19 98, BEFORE ME Michelle Lopez Nickelson
PERSONALLY APPEARED Dennis O'Brien (~~PERSONALLY APPEARED TO ME ON THE BASIS OF SATISFACTORY EVIDENCE~~) TO BE THE PERSON ~~WHOSE~~ WHOSE NAME IS/ARE HE SUBSCRIBED TO THE WITHIN INSTRUMENT AND ACKNOWLEDGED TO ME THAT HE/~~SHE~~ SHE EXECUTED THE SAME IN HIS/~~HER~~ HER AUTHORIZED CAPACITY ~~AND~~ AND THAT BY HIS/~~HER~~ SHE SIGNATURE (X) ON THE INSTRUMENT THE PERSON (X) OR THE ENTITY UPON BEHALF OF WHICH THE PERSON (X) ACTED, EXECUTED THE INSTRUMENT.

WITNESS MY HAND AND OFFICIAL SEAL.

SIGNATURE: Michelle Lopez Nickelson PRINTED NAME
NOTARY PUBLIC IN AND FOR SAID COUNTY AND STATE
MY COMMISSION EXPIRES: Sept. 5, 1998

The O'Brien Group
PRINCIPAL PLACE OF BUSINESS

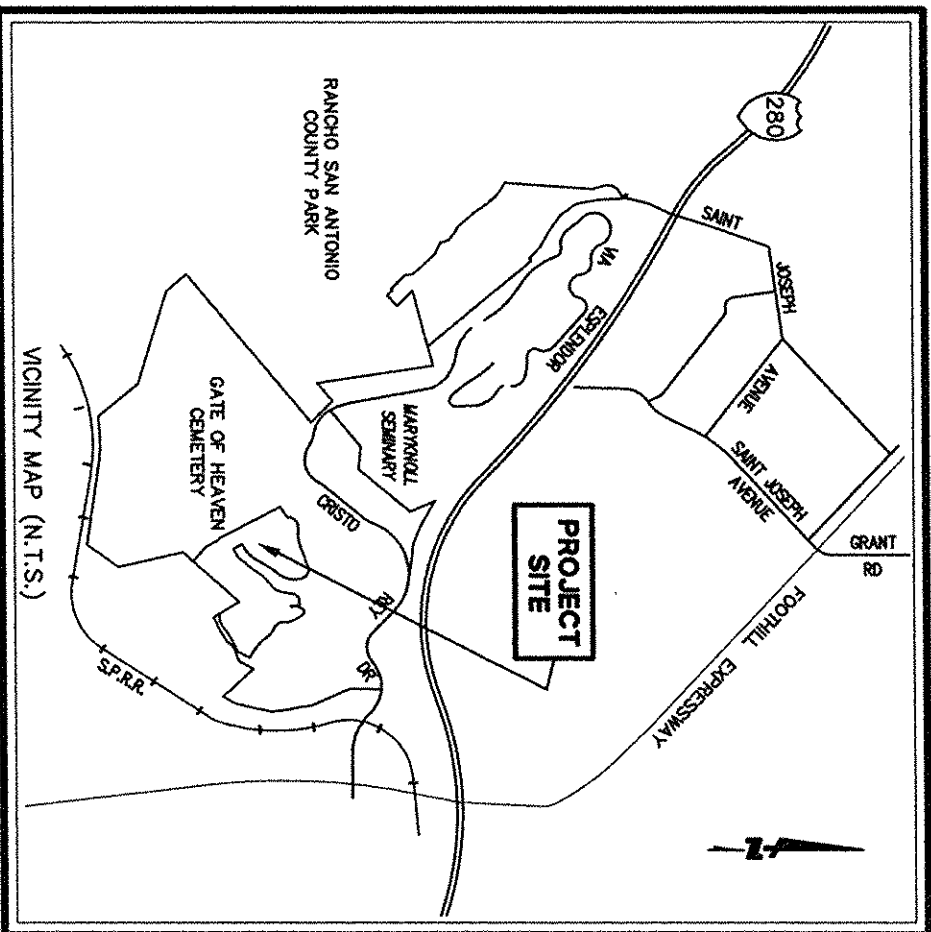

BASIS OF BEARINGS:

THE BEARING NORTH 81°41'40" EAST, BETWEEN TWO 3/4" IRON PIPE, ALONG THE NORTHERLY LINE (SHOWING A DISTANCE OF 812.29') OF THE "LANDS OF SANTA CLARA" AS SAID LANDS ARE SHOWN ON THAT CERTAIN RECORD OF SURVEY, FILED ON OCTOBER 2ND, 1979 IN BOOK 450 OF MAPS AT PAGE 41, SANTA CLARA COUNTY RECORDS, WAS USED AS THE BASIS OF ALL BEARINGS SHOWN ON THIS MAP.

TRUSTEES ACKNOWLEDGMENT

STATE OF CALIFORNIA)
) S.S.

COUNTY OF

ON 19 98, BEFORE ME
PERSONALLY APPEARED Michelle Lopez Nickelson (~~PERSONALLY APPEARED TO ME ON THE BASIS OF SATISFACTORY EVIDENCE~~) TO BE THE PERSON(S) WHOSE NAME(S) IS/ARE HE SUBSCRIBED TO THE WITHIN INSTRUMENT AND ACKNOWLEDGED TO ME THAT HE/~~SHE~~ SHE EXECUTED THE SAME IN HIS/~~HER~~ HER AUTHORIZED CAPACITY ~~(IES)~~ AND THAT BY HIS/~~HER~~ SHE SIGNATURE(S) (X) ON THE INSTRUMENT THE PERSON(S) OR THE ENTITY UPON BEHALF OF WHICH THE PERSON(S) ACTED, EXECUTED THE INSTRUMENT.

WITNESS MY HAND AND OFFICIAL SEAL.

SIGNATURE: _____ PRINTED NAME
NOTARY PUBLIC IN AND FOR SAID COUNTY AND STATE
MY COMMISSION EXPIRES: _____

The O'Brien Group
PRINCIPAL PLACE OF BUSINESS

SURVEYOR'S STATEMENT

THIS SURVEY AND FINAL MAP WAS MADE BY ME OR UNDER MY DIRECT SUPERVISION. THE SURVEY WAS MADE DURING THE MONTH OF MARCH, 1997 AND IS TRUE AND COMPLETE AS SHOWN. THE MONUMENTS ARE OF A CHARACTER AND OCCUR AT THE POSITIONS INDICATED, OR WILL BE SUFFICIENT TO ENABLE THE SURVEY TO BE RETRACED.

BRADLEY A. BILBO, F.L.S. #6141
EXPIRES: 03/31/2002

4/20/98 DATED

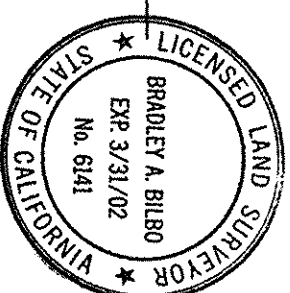

CITY ENGINEER'S STATEMENT

I HEREBY STATE THAT I HAVE EXAMINED THE HEREIN FINAL MAP OF TRACT NO. 9075, THAT THE SUBDIVISION AS SHOWN HEREON IS SUBSTANTIALLY THE SAME AS IT APPEARED ON THE TENTATIVE MAP, AND ANY APPROVED ALTERATIONS THEREON, THAT THE PROVISIONS OF THE SUBDIVISION MAP ACT, AS AMENDED, AND OF ANY LOCAL ORDINANCE APPLICABLE AT THE TIME OF APPROVAL OF THE TENTATIVE MAP HAVE BEEN COMPLIED WITH AND I AM SATISFIED THAT SAID MAP IS TECHNICALLY CORRECT.

CITY ENGINEER

Robert S. Cowan
BRIAN KANGAS FOULK, R.C.E. NO. 20468 DATE SEP 27, 1998
MY LICENSE EXPIRES SEPTEMBER 30, 2001

CITY CLERK'S STATEMENT

I, KIMBERLY SMITH, CITY CLERK OF THE CITY OF CUPERTINO, HEREBY STATE THAT THIS MAP WAS APPROVED BY THE CITY COUNCIL OF THE CITY OF CUPERTINO AT A MEETING OF SAID COUNCIL HELD ON THE 15th DAY OF JULY, 1998, AND THAT SAID COUNCIL DID ACCEPT THE DEDICATION OF STREETS AND EASEMENTS OFFERED FOR DEDICATION FOR PUBLIC USE.

Kimberly Smith
KIMBERLY SMITH, CITY CLERK AND EX-OFFICIO CLERK OF THE CITY COUNCIL OF THE CITY OF CUPERTINO, CALIFORNIA

PLANNING COMMISSIONS STATEMENT

THIS MAP IS CONSISTENT WITH THE TENTATIVE MAP APPROVED BY THE PLANNING COMMISSION, RESOLUTIONS NO. 4849, 4850, 4851 AND 4852 DATED DECEMBER 1, 1997

BY: DIRECTOR OF COMMUNITY DEVELOPMENT

Robert S. Cowan
ROBERT S. COWAN

SOILS REPORT

A SOILS REPORT HAS BEEN PREPARED BY THE FIRM OF HARZA ENGINEERING COMPANY OF CALIFORNIA (PROJECT #1840-G8) DATED DECEMBER 31, 1997 AND IS ON FILE WITH THE CITY OF CUPERTINO.

COUNTY RECORDER'S STATEMENT

FILE NO. 14374186 FEE: \$20.00 PAID: ✓
FILED FOR RECORD THIS 9th DAY OF JULY, 1998
AT 2:15 P.M. IN BOOK 450 OF MAPS AT PAGES 41-43 OF MAPS, SANTA CLARA COUNTY RECORDS, AT THE REQUEST OF BILLY MARTIN, F.L.S.
4765

BRENDA DAVIS, COUNTY RECORDER

BY: Brian Kangas Foulk
DEPUTY

TRACT NO. 9075
OAK VALLEY - UNIT 2

BEING A SUBDIVISION OF PARCEL A AS SAID PARCEL IS SHOWN ON THAT CERTAIN MAP ENTITLED "TRACT 9054 OAK VALLEY - UNIT 1" FILED FOR RECORD ON 11/19/98 1998 IN BOOK 705 OF MAPS
AT PAGES 13 THROUGH 23 SANTA CLARA COUNTY RECORDS.
CITY OF CUPERTINO COUNTY OF SANTA CLARA STATE OF CALIFORNIA

DATED: JUNE 1998

Brian Kangas Foulk

SURVEYORS - ENGINEERS - PLANNERS
540 PRICE AVENUE
REDWOOD CITY, CA 94063