

OUTSIDE CORNER DETAIL

Scale= 3" = 1'-0"

SERVICE COUNTER ISOMETRIC

Scale= 3/4" = 1'-0"

TILE SCHEDULE							INSTALLED AND FURNISHED BY: G.C. UNLESS NOTED OTHERWISE	01-11-19
NO.	MANUFACTURER	DESCRIPTION	COLOR	FINISH	JOINT	GROUT	REMARK	
T-108	CMC DOUG SALATINO 518-713-5371	12" X 24" X 3/8"	-	-	1 / 8"	G-111	RESTROOM WALL	
T-111	DALTILE	6" X 36" X 3/8" 9" X 36" X 3/8"	FOREST PARK - SUMMERTREE FP95	MATTE	1/8"	G-115	RR VESTIBULE & DINING ROOM WALLS CONTACT: NATIONAL ACCOUNT SUPPORT DESK 877.556.5728 (national.accounts@daltile.com)	
T-200	CMC DOUG SALATINO 518-713-5371	24" X 24"	BRAVADA GREIGE	MATTE	1/8"	G-96	DINING & RESTROOM FLOOR	
T-300	EMSER - ECHO	3" HEXAGON	CALACATTA	MATTE	1/8"	G-114	BEVERAGE COUNTER BACKSPASH AND SERVICE COUNTER	
T-402	CMC DOUG SALATINO 518-713-5371	8" HEXAGON ROUNDOABOUT	GREY	MATTE	1/8"	G-107	DINING ROOM FEATURE AREA	
S1	SILIKAL	QUARTZ BLEND #4	-	PLAIN	-	-	KITCHEN, SERVICE FLOOR CONTACT: MARK FELDMAN 770-830-1404 (mfieldman@silikalamerica.com)	
S2	SILIKAL	QUARTZ BLEND #4	-	ABRASIVE	-	-	JOHN COTHRAN 888-830-1404 (cotthran@silikalamerica.com)	
GROUT	MANUFACTURER	DESCRIPTION	MFG.	COLOR	FINISH		REMARK	
G-96	MAPEI 800.42.MAPEI WWW.MAPEI.COM	LATEX MODIFIED GROUT	11	SAHARA BEIGE	POLY BLEND 1 / 8" NON-SANDED		DINING & RESTROOM FLOOR APPLY GROUT SEALER	
G-107	MAPEI 800.42.MAPEI WWW.MAPEI.COM	LATEX MODIFIED GROUT	107	IRON	POLY BLEND 1 / 8" NON-SANDED		DINING ROOM FLOOR APPLY GROUT SEALER	
G-111	MAPEI 800.42.MAPEI WWW.MAPEI.COM	LATEX MODIFIED GROUT	19	PEARL GREY	POLY BLEND 1 / 8" NON-SANDED		RESTROOM, DINING APPLY GROUT SEALER	
G-113	MAPEI 800.42.MAPEI WWW.MAPEI.COM	LATEX MODIFIED GROUT	07	CHOCOLATE	POLY BLEND 1 / 8" NON-SANDED		APPLY GROUT SEALER	
G-114	MAPEI 800.42.MAPEI WWW.MAPEI.COM	LATEX MODIFIED GROUT	19	PEARL GREY	POLY BLEND 1 / 8" NON-SANDED		BEVERAGE COUNTER BACKSPASH APPLY GROUT SEALER	
G-115	MAPEI 800.42.MAPEI WWW.MAPEI.COM	LATEX MODIFIED GROUT	42	MOCHA	POLY BLEND 1 / 8" NON-SANDED		APPLY GROUT SEALER	

- * REFER A-200 EXTERIOR FINISH SCHEDULE FOR EXTERIOR DECORATIVE TILE
- * SCHLUTER SYSTEM ALUMINUM TRIM:
- COVE TILE TRIM: INSTALLED AT RESTROOM, SERVICE COUNTER, AND DRINK STATION
SCHLUTER SYSTEMS DILEX-AHK 1S 125 ATGB (BRUSHED NICKEL ANODIZED ALUMINUM)
-OUTSIDE CORNER CONNECTOR PIECE: DILEX-AHK-E90/AHK 1S 125 ATGB (BRUSHED NICKEL ANODIZED ALUMINUM)
-INSIDE CORNER CONNECTOR PIECE: DILEX-AHK-I90/AHK 1S 125 ATGB (BRUSHED NICKEL ANODIZED ALUMINUM)
-END CAP PIECE: DILEX-AHK-E/AHK 1S 125 ATGB (BRUSHED NICKEL ANODIZED ALUMINUM)
- EDGE TILE TRIM:
SCHLUTER SYSTEMS RONDEC-RO125 ATGB (BRUSHED NICKEL ANODIZED ALUMINUM)
-OUTSIDE CORNER CONNECTOR PIECE: RONDEC-EV/RO125 ATGB (BRUSHED NICKEL ANODIZED ALUMINUM)
-INSIDE CORNER CONNECTOR PIECE: RONDEC-I2/RO125 ATGB (BRUSHED NICKEL ANODIZED ALUMINUM)
SCHLUTER SYSTEMS RONDEC-RO80 ATGB (BRUSHED NICKEL ANODIZED ALUMINUM)
-OUTSIDE CORNER CONNECTOR PIECE: RONDEC-EV/RO80 ATGB (BRUSHED NICKEL ANODIZED ALUMINUM)
-INSIDE CORNER CONNECTOR PIECE: RONDEC-I2/RO80 ATGB (BRUSHED NICKEL ANODIZED ALUMINUM)
SCHLUTER SYSTEMS JULY-A-80 ATGB (BRUSHED NICKEL ANODIZED ALUMINUM)
-OUTSIDE EDGE PROTECTION PIECE

* EPOXY GROUT BY MAPEI, KERAPOXY IEG, 100% SOLIDS INDUSTRIAL GRADE:
AREAS: UNDER HOOD AND 36" IN FRONT OF COOKING LINE, 3 COMPARTMENT SINK AND MOP SINK AREA
SEE MANUFACTURER'S SPECIFICATION, DETAILS AND GUIDE FOR PREPARATION,
MIXING, GROUTING AND CLEANING INSTRUCTION
NOTE: SEE INTERIOR SHEETS FOR WALL/BASE TILE LOCATIONS AND SPECIFICATIONS

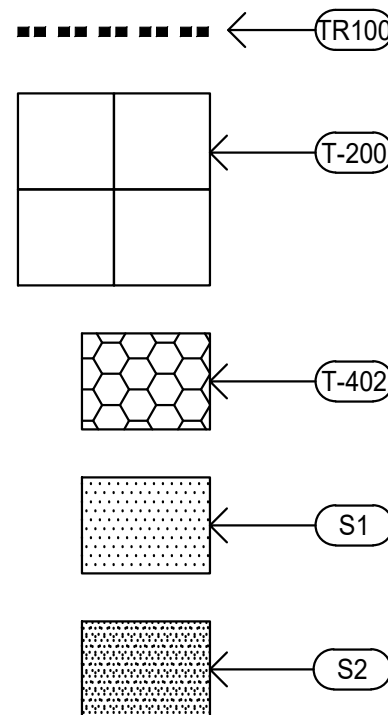

FINISH SCHEDULE

Scale= NTS

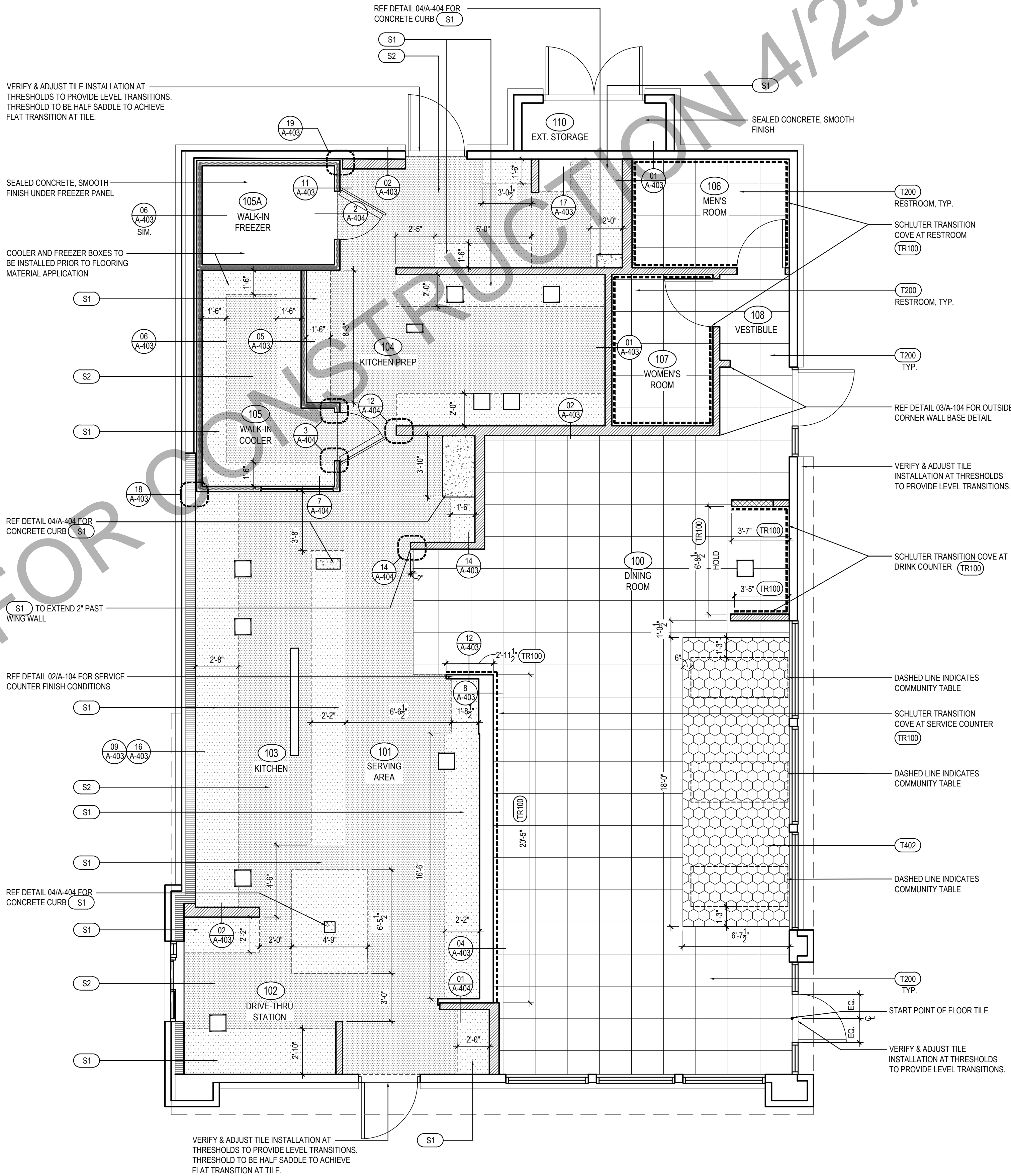

FINISH PLAN

Scale= 1/4" = 1'-0"



PANDA RESTAURANT GROUP INC.
1683 Walnut Grove Ave.
Rosemead, California
91770
Telephone: 626.799.9898
Facsimile: 626.372.8288

All ideas, designs, arrangement and plans indicated or represented by this drawing are the property of Panda Express Inc. and were created for use on this specific project. None of these ideas, designs, arrangements or plans may be used by or disclosed to any person, firm, or corporation without the written permission of Panda Express Inc.

REVISIONS:

ISSUE DATE:

1 03.04.2022 ISSUE FOR PERMIT

DRAWN BY: JDV

PANDA PROJECT #: S8-22-D8698
C&P PROJECT #: 2210806



2600 Maitland Center Parkway
Suite #200
Maitland, FL 32751
P (407) 661-9100
F (407) 661-9101
c-p.com

03.04.2022



PANDA EXPRESS

TRUE WARM AND WELCOME 2200
3030 DERITA ROAD
CONCORD, NC 28027

A-104

FINISH PLAN AND SCHEDULE

TRUE WARM & WELCOME 2200 R4