

CORNER RECORD

Agency Index

BK 98 PG-27

Document Number

CR 10209

City of San LorenzoCounty of Alameda

, California

Brief Legal Description Mon @ Via Manzanitas & Via Del Rey

CORNER TYPE

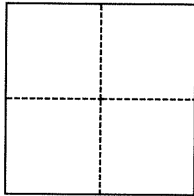

- ☐ Government Corner ☒ Control
☐ Meander ☐ Property
☐ Rancho ☐ Other

Date of Survey 5-29-17

COORDINATES (Optional)

N. 2071357.51 E. 6088437.28Elevation —

Units

☐ Metric☒ U.S. Survey FootHorizontal Datum —Zone 3Epoch Date —Vertical Datum —☐ Complies with Public Resources Code §§8801-8819☐ Complies with Public Resources Code §§8890-8902

PLS Act Ref.:

☐ 8765(d)☒ 8771☐ 8773☐ Other:Corner/
Monument:☒ Left as found☐ Established☐ Rebuilt☒ Pre-Construction☐ Found and tagged☐ Reestablished☐ Referenced☐ Post-Construction

Narrative of corner identified and monument as found, set, reset, replaced, or removed:

☐ See sheet #2 for description(s):City Monument

SURVEYOR'S STATEMENT

This Corner Record was prepared by me or under my direction in conformance with

the Professional Land Surveyors' Act on 6-5-17Signed Joseph M. Brajkovich

P.L.S. or R.C.E. No.

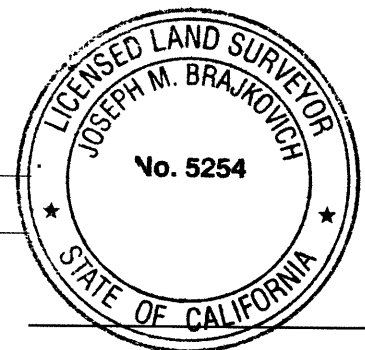
5254

COUNTY SURVEYOR'S STATEMENT

This Corner Record was received 23 JUNE, 2017and examined and filed 8 AUGUST, 2017Signed Michael Rubner

P.L.S. or R.C.E. No.

6843Title COUNTY SURVEYOR

County Surveyor's Comment

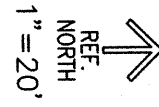

LEGEND

- MONUMENT
- CUT X

