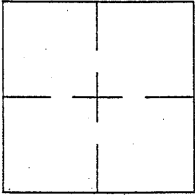

CORNER RECORD

Document Number CR 5929City of CASTRO VALLEYCounty of ALAMEDA, CaliforniaBrief Legal Description IRON PIN MONUMENT LOCATED WITHIN THE INTERSECTION OF IONE AVENUE AND IDENA AVENUE.

CORNER RECORD

Government Corner ☐ Control ☒
 Meander ☐ Property ☐
 Rancho ☐ Other ☐
 Date of Survey 10/29/13

COORDINATES
(Optional)

N. _____
 E. _____
 Zone _____ Datum _____
 Elev. _____

Corner — Left as found ☒ Found and tagged ☐ Established ☐ Reestablished ☐ Rebuilt ☐

Identification and type of corner found: Evidence used to identify or procedure used to establish or reestablish the corner:
FOUND IRON PIN IN MONUMENT WELL LOCATED WITHIN THE INTERSECTION OF IONE AVENUE AND IDENA AVENUE.

(REFERENCE ADDRESS: 2652 IONE AVE)

THIS POINT WAS REFERENCED PRIOR TO A CONSTRUCTION PROJECT IN THE VICINITY.

A description of the physical condition of the monument as found and as set or reset:
FOUND AND SET POINTS AS SHOWN ON PAGE 2.

THESE TIES ARE FOR THE PURPOSE OF PERPETUATING THE FOUND MONUMENTATION.

NO CLAIM IS MADE AS TO THE RELATIONSHIP OF THE POINTS OR LINES SHOWN HEREON TO TRUE BOUNDARY LOCATIONS.

SURVEYOR'S STATEMENT

This Corner Record was prepared by me or under my direction in conformance with the Land Surveyors' Act on NOVEMBER 4, 2013.
 Signed Vincent H. Cunha L.S. Number LS 4520
VINCENT H. CUNHA

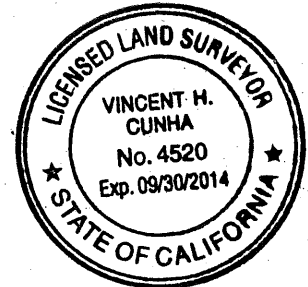

COUNTY SURVEYOR'S STATEMENT

This Corner Record was received 11-6-13 and examined
 and filed 1-9-2014.
 Signed Russell R. Penland Title County Surveyor

County Surveyor's Comment _____

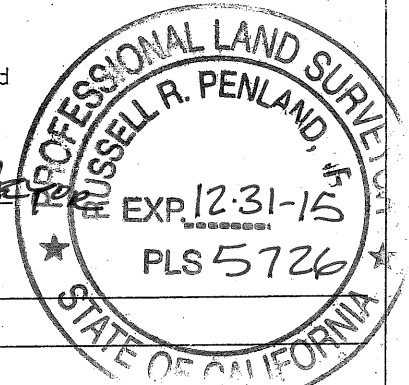

477204

SCALE: 1"=20'

LEGEND

- FOUND IRON PIN MONUMENT
- ✕ SET CUT CROSS IN CONCRETE
- AA##A# ALAMEDA COUNTY MONUMENT ID

