

# CORNER RECORD

Agency Index

BK 149 PG 72

Document Number CR 16255

City of UNINCORPORATED (SAN LORENZO) County of ALAMEDA, California

Brief Legal Description INTERSECTION HESPERIAN BOULEVARD &amp; GRANT AVENUE

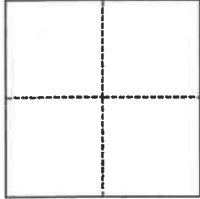
**CORNER TYPE****COORDINATES (Optional)**

- ☐ Government Corner ☐ Control  
☐ Meander ☐ Property  
☐ Rancho ☒ Other

Date of Survey May 23, 2022

N. \_\_\_\_\_ E. \_\_\_\_\_

Elevation \_\_\_\_\_

Units ☐ Metric ☐ U.S. Survey Foot

Horizontal Datum \_\_\_\_\_

Zone \_\_\_\_\_ Epoch Date \_\_\_\_\_

Vertical Datum \_\_\_\_\_

☐ Complies with Public Resources Code §§8801-8819☐ Complies with Public Resources Code §§8890-8902

PLS Act Ref.:

☐ 8765(d)☒ 8771☐ 8773☐ Other:Corner/  
Monument:☒ Left as found☐ Established☐ Rebuilt☒ Pre-Construction☐ Found and tagged☐ Reestablished☒ Referenced☐ Post-Construction

Narrative of corner identified and monument as found, set, reset, replaced, or removed:

☐ See sheet #2 for description(s):

FOUND MONUMENT PER RS 2827 (43 RS 2) AS SHOWN ON SIDE 2. SET BRASS NAILS & TAGS STAMPED "ALA CO SURV" IN LEAD IN TOP OF CURB, UNLESS OTHERWISE NOTED, AS STRADDLERS FOR FOUND MONUMENT. UPDATE OF PREVIOUS 8771(b) CORNER RECORD ON FILE, CR 10006. REFERENCE POINTS WERE DESTROYED DUE TO SIDEWALK IMPROVEMENTS.

**SURVEYOR'S STATEMENT**

This Corner Record was prepared by me or under my direction in conformance with

the Professional Land Surveyors' Act on August 17, 2022

Signed

(P.L.S.) or R.C.E. No.

8427

**COUNTY SURVEYOR'S STATEMENT**

This Corner Record was received

and examined and filed

SEP 28 2022

Signed

(P.L.S.) or R.C.E. No.

7010

Title ALAMEDA COUNTY SURVEYOR

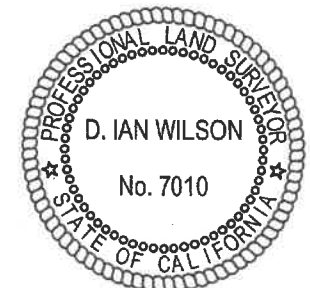

County Surveyor's Comment

